



48-INCH DUAL-FUEL RANGE

HDPR48 | PROFESSIONAL STYLE



AVAILABLE MODELS

HDPR48S/NG	48" Professional Dual Fuel Pro Range - Stainless Steel Natural Gas
HDPR48S/NG/H	48" Professional Dual Fuel Pro Range - Stainless Steel Natural Gas High Altitude
HDPR48S/LP	48" Professional Dual Fuel Pro Range - Stainless Steel Liquid
HDPR48S/LP/H	48" Professional Dual Fuel Pro Range - Stainless Steel Liquid Propane High Altitude
HDPR48C/NG	48" Professional Dual Fuel Pro Range - Color Match Natural Gas
HDPR48C/NG/H	48" Professional Dual Fuel Pro Range - Color Match Natural Gas High Altitude
HDPR48C/LP	48" Professional Dual Fuel Pro Range - Color Match Liquid Propane
HDPR48C/LP/H	48" Professional Dual Fuel Pro Range - Color Match Liquid Propane High Altitude

FEATURES & BENEFITS

- Exclusive Four-Part Pure Convection - heating element, air baffle, fan and filter to precisely distribute heat for superior cooking results.
- Large oven capacity - 5.2 cu. ft. / 2.8 cu. ft.
- 6 Dual-Stack Sealed Burners.
- Powerful 18K BTU and true simmer burners.
- Illumina™ Knobs - White LED
- LED Tilt-Vue™ Glass Touch Control
- Soft Close Oven Doors
- Continuous Grate Platform
- All Brass Valves, Heads and Caps

ADDITIONAL FEATURES

CLEANING TYPE	SELF CLEAN (BOTH) GREENCLEAN™ (BOTH OVENS)
TYPE OF GRATE	CONTINUOUS CAST IRON
CAVITY	BLACK ENAMEL COATING
RACK POSITIONS	6 (LG) / 6 (SM)
LIGHTING	LED & HALOGEN

GENERAL PROPERTIES

OVEN CAPACITY (CUBIC FEET)	5.2 (LG OVEN) / 2.8 (SM OVEN)
COOKING MODES BOTH OVENS	PURE CONVECTION™ CONVECTION BAKE CONVECTION BROIL CONVECTION ROAST BAKE BROIL

OVEN PERFORMANCE

BAKE ELEMENT	3,000W - 8 PASS (LG) 2,100W (SM)
BROIL ELEMENT	3,500W - 8 PASS (LG) 2,500W (SM)
CONVECTION ELEMENT	2,200W (LG) 2,200W (SM)

BURNER PERFORMANCE

TOTAL NUMBER OF COOKTOP BURNERS	6 DUAL STACK BRASS BURNERS
LEFT FRONT (BTU)	18,000 DUAL (SIMMER/SEAR)
LEFT REAR (BTU)	15,000 STACK DUAL (SIMMER)
CENTER FRONT (BTU)	15,000 STACK DUAL (SIMMER)
CENTER REAR (BTU)	15,000 STACK DUAL (SIMMER)
RIGHT FRONT (BTU)	18,000 DUAL (SIMMER/SEAR)
RIGHT REAR (BTU)	15,000 STACK DUAL (SIMMER)
SEALED BURNERS	YES
PERMA-FLAME™ (AUTO RE-IGNITION)	YES

ADDITIONAL MODES

KEEP WARM	YES (BOTH)
PROOF	YES (BOTH)
TEMPERATURE PROBE	YES (LG OVEN)
DEHYDRATE	YES (BOTH)
SABBATH	YES (BOTH)

CONTROL FEATURES

LED (WHITE)	YES
NUMBER OF KNOBS	6 KNOBS
CONTROL METHOD	LED GLASS TOUCH CONT
ILLUMINA™ BURNER KNOBS	YES
HIGHLIGHTING COLOR	WHITE
CLOCK	YES
DELAY START	YES
KITCHEN TIMER	YES 1 PER OVEN
TIME OF DAY (12 HR/24 HR)	YES
TEMPERATURE (F/C)	YES
CHILD LOCK	YES
SOUND ON/OFF	YES

TECHNICAL DETAILS

CIRCUIT BREAKER (A)	50 AMP
VOLTS (V)	240 V
FREQUENCY (HZ)	60 HZ
ENERGY SOURCE	GAS AND ELECTRICAL
GAS TYPES	NATURAL GAS NATURAL GAS (HIGH ALTITUDE) LIQUID PROPANE LIQUID PROPANE (HIGH ALTITUDE)

DIMENSIONS & WEIGHT

APPLIANCE DIMENSIONS (W X H X D) (IN.)	47 7/8" X 36 1/4" - 37 1/2" X 26 15/16"
REQUIRED CUTOUT SIZE (W X D) (IN.)	48" minimum X 24"

dacor 48-INCH DUAL-FUEL RANGE

APPLIANCE DIMENSIONS

48"

A (WIDTH)	47 7/8" (121.6CM)
B (DEPTH)	26 15/16" (68.4CM)
C (HEIGHT)	36 1/4" TO 37 1/2" (92.0-95.3CM)

Product tolerances: $\pm 1/16"$ ($\pm 1.6\text{MM}$)

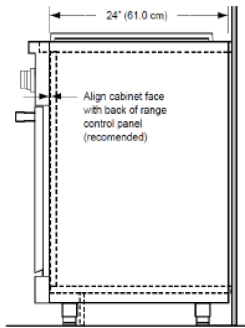
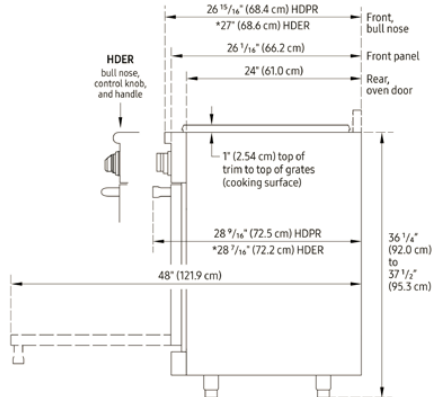

View of Range Installed (Side View)

CABINET CUT-OUT DIMENSIONS

RANGE MODEL	F	G
HDPR48	54" (137.2 CM)* 48" (121.9 CM)**	48" (121.9 CM)**

* Recommended
** Minimum

Cutout tolerances: $\pm 1/16"$ ($\pm 1.6\text{ mm}$), -0 unless otherwise stated

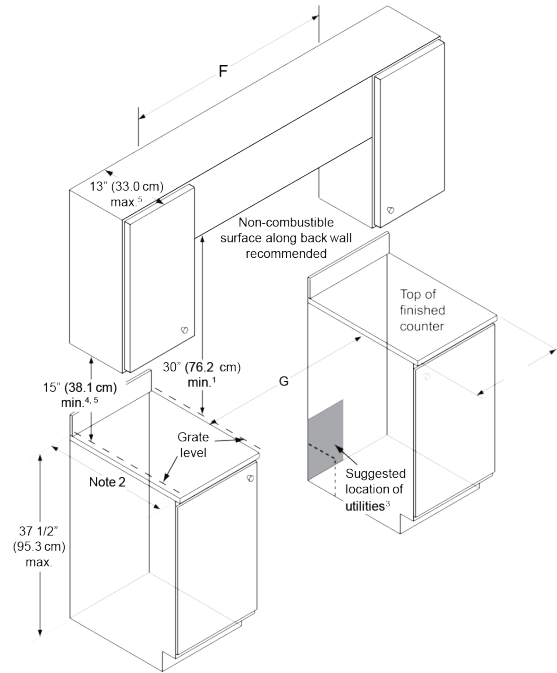

ACCESSORIES (INCLUDED)

GLIDERACK™	2 (LG) & 2 (SM)
STANDARD RACK	1 (LG) / 1 (SM)
TEMPERATURE PROBE	1 LG OVEN
WOK RING	1
CONVECTION FILTER	1/EA OVEN
BRASS/BLACK PORCELAIN BURNER CAPS	6/EA
REMOVABLE NON-STICK GRIDDLE	1

ACCESSORIES (OPTIONAL)

COOKIE SHEETS (SET OF 3)	SKU - ACSRO303
REMOVABLE NON-STICK GRIDDLE	SKU - AG30
BROIL/ROASTING PAN W/GRILL & V RACK	SKU - AORPVR
STAINLESS STEEL BACKGUARD, MOUNTS TO UNIT (3 IN HIGH)	AHB48D3
STAINLESS STEEL BACKGUARD, MOUNTS TO UNIT (9 IN HIGH)	AHB48D9
EPICURE HANDLE SET, 48" RANGE	AHHESR48

WARRANTY

LIMITED, PARTS AND LABOR

1 YEAR