

# DV22K6800EW

SAMSUNG

## Samsung 24" Front-Load Electric Dryer

4.0 cu. ft. Capacity DOE



### Signature Features

#### Smart Care

- Smart Care interacts with your washer and dryer to perform an immediate diagnosis and offer quick solutions.

#### Sensor Dry

- Optimizes cycle time and temperature to dry clothes thoroughly, while preventing heat damage.

#### 12 Preset Drying Cycles

- Covers almost any drying need for your active family.

### Available Color



White



Smart Care

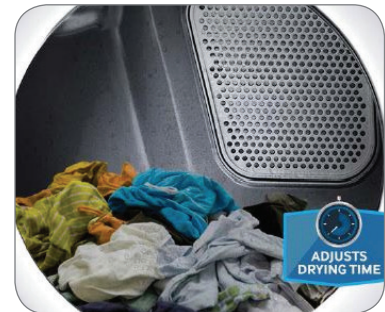

Sensor Dry

### Features

- Smart Care
- Sensor Dry
- 12 Preset Dry Cycles
- 8 Options
- Stainless Steel Drum
- 5 Temperature Settings
- 5 Timed Dry Settings
- 4-Way Venting
- Dryer Drum Light
- Reversible See-Through Door

### Convenience

- Child Lock
- Filter Check Indicator

### Rating

260 kWh/yr

# DV22K6800EW

# SAMSUNG

## Samsung 24" Front-Load Electric Dryer

4.0 cu. ft. Capacity DOE

### Installation Specifications

If the washer and dryer are installed together or the dryer alone, the closet front must have two unobstructed air openings for a combined minimum total area of 72-inch<sup>2</sup> (see stacked build below). Your washer alone does not require a specific air opening.

#### 1. Alcove or closet installation

Minimum Clearance for Closet and Alcove Installations:

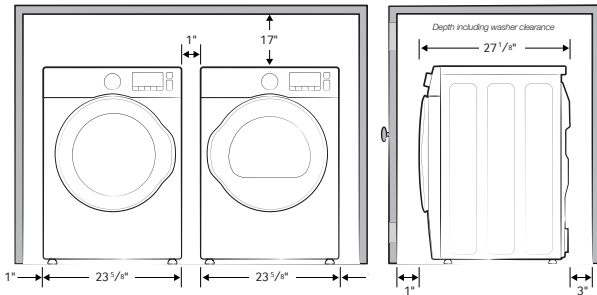

#### 2. With stacked washer and dryer

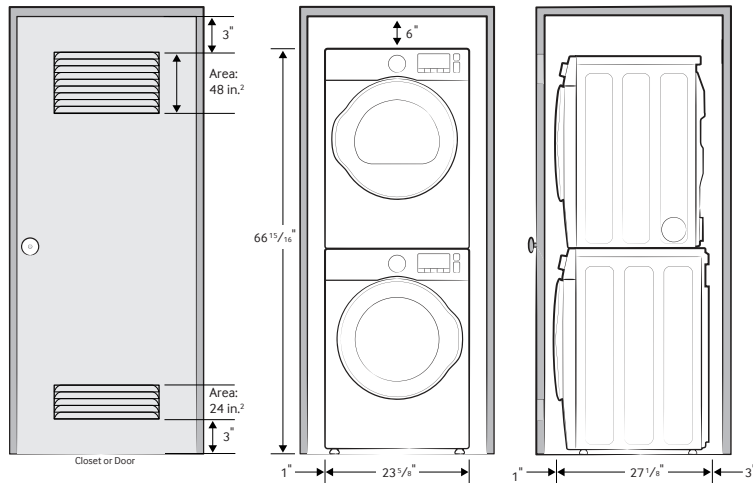

### Dimensions

Required Dimensions for Installation with Pedestal:

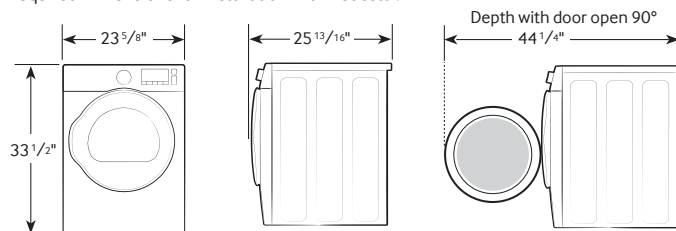

#### 4-Way Venting

#### 12 Preset Dry Cycles:

Normal, Heavy Duty, Towels, Permanent Press, Active Wear, Delicates, Wool, Sanitize, Time Dry, Air Fluff, Quick Dry, Wrinkle Release

#### 8 Options:

Mixed Load Bell, Wrinkle Prevent, My Cycle, Adjust Time, Sound, Child Lock, Smart Care, Drum Light

#### 5 Temperature Settings:

High, Medium, Medium Low, Low, Extra Low

#### 5 Dry Levels:

Very Dry, More Dry, Normal Dry, Less Dry, Damp Dry

#### Warranty

One (1) Year Parts and Labor

#### Product Dimensions & Weight (WxHxD)

Dimensions: 23<sup>5</sup>/<sub>8</sub>" x 33<sup>1</sup>/<sub>2</sub>" x 25<sup>13</sup>/<sub>16</sub>"

Weight: 88 lbs

#### Shipping Dimensions & Weight (WxHxD)

Dimensions: 26<sup>1</sup>/<sub>4</sub>" x 35" x 27<sup>1</sup>/<sub>2</sub>"

Weight: 93 lbs

#### Electric

White

#### Model #

DV22K6800EW

#### UPC Code

887276124537

#### Matching Washer

White

WW22K6800AW

887276126876

#### Optional Stacking Kit

Sold separately SK-DH

887276151052

#### Optional Side Vent Kit

Sold separately DV-2A/XAA

887276146416