

DVE22N6850X

SAMSUNG

Samsung 24" Front-Load Electric Dryer

4.0 cu. ft. Capacity DOE



Signature Features

Smart Care

- Smart Care interacts with your dryer to perform an immediate diagnosis and offer quick solutions.

Sensor Dry

- Optimizes cycle time and temperature to dry clothes thoroughly, while preventing heat damage.

14 Preset Drying Cycles

- Covers almost any drying need for your active family.

Available Color



Inox Grey

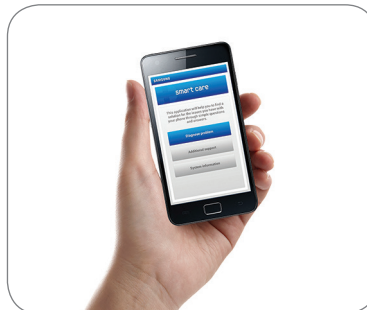

Smart Care



Sensor Dry

Features

- Smart Care
- Sensor Dry
- 14 Preset Drying Cycles
- 24"-Wide – Fits in the tightest quarters
- 8 Options
- 5 Temperature Settings
- Interior Drum Light
- Ice Blue LED Display
- Crystal Blue Door
- Wrinkle Prevent Option
- Stainless Steel Drum

Convenience

- Child Lock

Rating

260 kWh/yr

DVE22N6850X

SAMSUNG

Samsung 24" Front-Load Electric Dryer

4.0 cu. ft. Capacity DOE

Installation Specifications

If the washer and dryer are installed together or the dryer alone, the closet front must have two unobstructed air openings for a combined minimum total area of 72-inch² (see stacked build below). Your washer alone does not require a specific air opening.

1. Alcove or closet installation

Minimum Clearance for Closet and Alcove Installations:

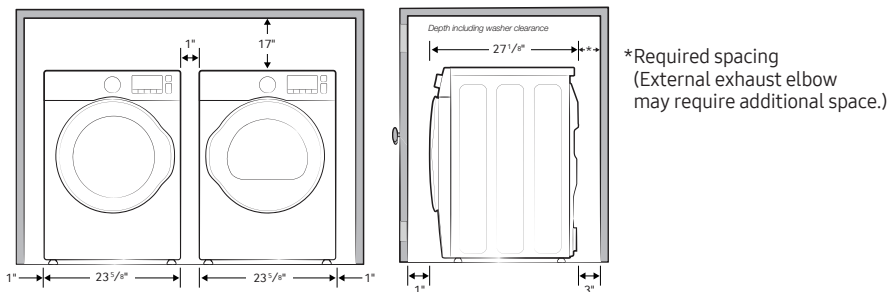

2. With stacked washer and dryer

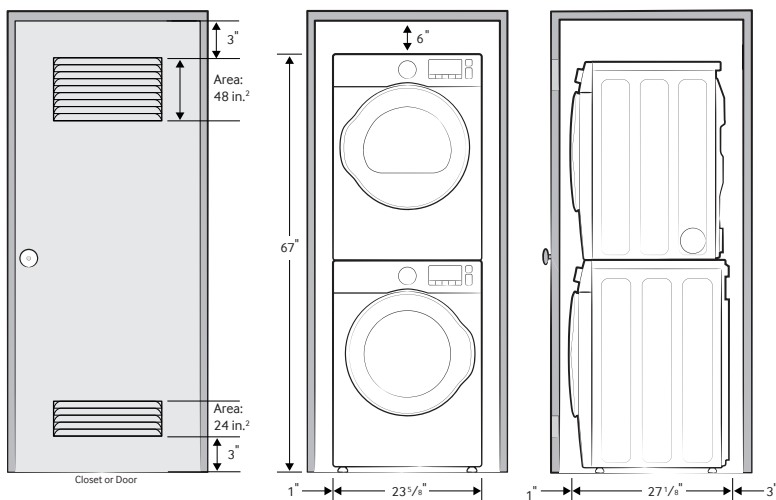

Dimensions

Required Dimensions for Installation with Pedestal:

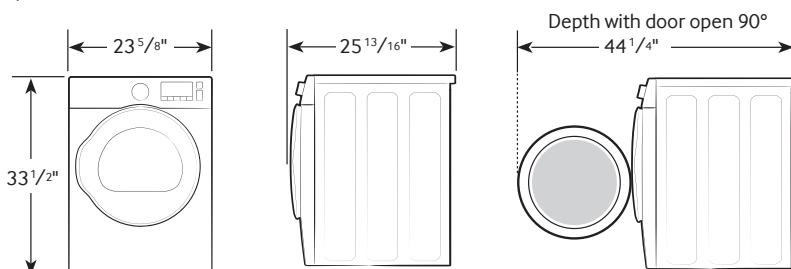

4.0 cu. ft. Capacity DOE

4-Way Venting

14 Preset Dry Cycles:

Normal, Heavy Duty, Mixed Load, Towels, Permanent Press, Active Wear, Jeans, Delicates, Wool, Sanitize, Time Dry, Air Fluff, 30' Express, Wrinkle Release

8 Options:

Mixed Load Bell, Wrinkle Prevent, My Cycle, Adjust Time, Sound Off, Child Lock, Smart Care, Drum Light

5 Temperature Settings:

High, Medium, Medium Low, Low, Extra Low

5 Dry Levels:

Very Dry, More Dry, Normal Dry, Less Dry, Damp Dry

Warranty

One (1) Year Parts and Labor

Product Dimensions & Weight (WxHxD)

Dimensions: 23⁵/₈" x 33¹/₂" x 25¹³/₁₆"
Weight: 88 lbs

Shipping Dimensions & Weight (WxHxD)

Dimensions: 26¹/₄" x 35" x 27¹/₂"
Weight: 93 lbs

Electric

Inox Grey

Model

DVE22N6850X

UPC Code

887276261850

Matching Washer

Inox Grey

WW22N6850QX

887276261652

Optional Stacking Kit

Sold separately SK-DH

887276151052

Optional Side Vent Kit

Sold separately DV-2A/XAA

887276146416